

On the *Lighter* Side

What would you do?

A farmer named Clyde had a car accident. In court, the trucking company's hot shot lawyer was questioning Clyde. "Didn't you say, at the scene of the accident, 'I'm fine,?' " asked the lawyer.

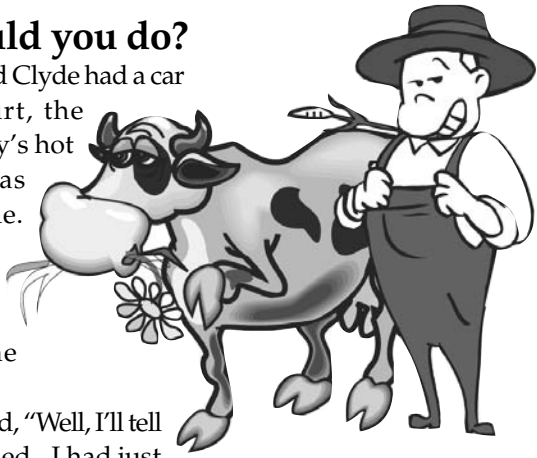

Clyde responded, "Well, I'll tell you what happened. I had just loaded my favorite cow, Bessie, into the..."

"I didn't ask for any details," the lawyer interrupted. "Just answer the question, please. Did you or did you not say at the scene of the accident, 'I'm fine!'"

Clyde said, "Well, I had just got Bessie into the trailer and I was driving down the road..."

The lawyer interrupted again and said, "Your Honor, I am trying to establish the fact that, at the scene of the accident, this man told the Highway Patrolman on the scene that he was just fine. Now several weeks after the accident he is trying to sue my client. I believe he is a fraud. Please tell him to simply answer the question."

By this time the Judge was interested in Clyde's answer and said to the lawyer, "I'd like to hear what he has to say about his favorite cow, Bessie."

Clyde thanked the Judge and proceeded. "Well, as I was saying, I had just loaded Bessie, my favorite cow, into the trailer and was driving her down the highway when this huge semi-truck and trailer ran the stop sign and smacked my truck right in the side. I was thrown into one ditch and Bessie was thrown into the other. I was hurting real bad and didn't want to move.

"However, I could hear old Bessie moaning and groaning. I knew she was in terrible shape just by her groans. Shortly after the accident a Highway Patrolman came on the scene. He could hear Bessie moaning and groaning, so he went over to her. After he looked at her, and saw her fatal condition, he took out his gun and shot her between the eyes. Then the Patrolman came across the road, gun still in hand, looked at me, and said, 'How are you feeling?'

"Now tell me, what would you say?"

**golden
corral**

GOLDEN CORRAL CORPORATION
Company Operations - East
5151 Glenwood Ave.
Raleigh, NC 27612

Rick Eggemeyer
Operating Partner

7043 Normandy Blvd.
Jacksonville, FL 32205

Tel: (904) 378-3688
Fax: (904) 378-3689



**Surety
Associates, Inc.**
Construction Insurance Corp.

2110 Herschel Street
Jacksonville, Florida
32204
(904) 388-5002
Fax (904) 384-9827
Mobile (904) 708-3040

Troy Taylor INSURANCE AGENCY

TROY TAYLOR
Independent Agent

Tel: (904) 389-7514
Tel: (904) 387-2461
Fax: (904) 387-0356
troytaylorinsurance.com

We sell...

- Auto
- Homeowners
- Flood
- Commercial and Bond Insurance

1128 Edgewood Avenue South, Jacksonville, Florida



Fleet - Construction - Trucks

Looking for that special shop for your vehicle?

Equipment repairs with specialty in A/C - Electric
Wire Repairs - Alternators and Starters
Units in stock or rebuild yours

From Jetskis to H.D. Equipment - large inventory
Bosch-Delco-Leece Neville-ND-Maretti

■ Viking Auto Electric & Air, Inc. ■

4521 Sunbeam Road
Mon-Fri 7:30 am-5:00 pm (904) 731-5065

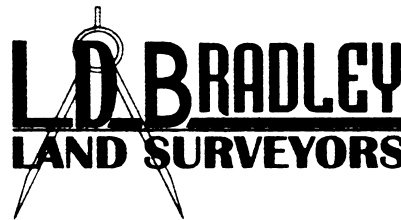

5773 Normandy Boulevard, Jacksonville, Florida 32205
Phone: (904) 786-6400 • Fax: (904) 786-1479
djohnson@ldbradley.net

Land • Topographic • Hydrographic • Precise Geodetic Control
Highway & Global Positioning Systems

E-MAIL THE EDITOR

*Do you
have any
story ideas,
comments
or
editorial
for our
newspaper?*

*I look forward to
hearing from you.
e-mail me at...*

**sshaw@
justicecoalition.org**

A Taste of Old Florida

Cross Creek Steakhouse & Rib

Come on in and enjoy a Great Steak,
Tender fall-off-the-bone Ribs,
Or our famous Jumbo fried Shrimp.

\$3.00 off
Good on any Entrée
Limit 1 per customer
Not valid with any other special or offer

Cross Creek Gift Cards
Perfect for Every Occasion



Two locations to serve you in Jacksonville
Lane Ave & I-10 • 904-783-9579
Lem Turner Road & I-295 • 904-765-7420

www.crosscreeksteaks.com